

## Single Point / Gap Frame Power Presses

# OCP



27 . 38 . 49 . 66 . 88 . 121 . 176 . 220 . 286 . 330 tons

# Stamtec - OCP Series

World leader in GAP FRAME PRESS design



The new Stamtec OCP single point, gap frame press offers more features and more design advances than any similar machine. What's more, you'll be pleased at the very competitive pricing and the choice of many models from our large inventory of stock machines.

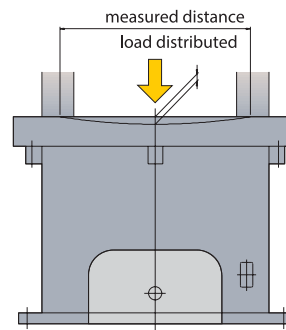

Exceptional resistance to deflection is a hallmark of Stamtec press design. You'll be impressed with the part quality and die life that the OCP delivers.

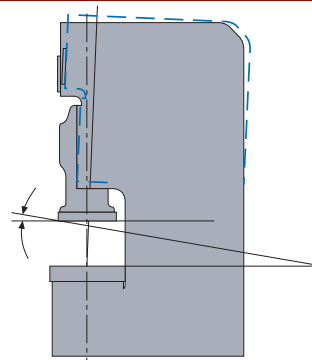

The heavy, one-piece welded steel frame is fully stress relieved and designed to resist deflection and provide accurate stampings and longer die life.

## STANDARD Features

- Wet clutch and brake
- Flywheel brake
- Hydraulic overload system
- Air counterbalance system
- Automatic lubrication system
- Motorized slide adjustment (on presses over 35 tons)
- Digital die height indicator
- Knockout bar
- Removable, flanged, T-slotted slide plate and bolster
- Press control with:
  - » Programmable limit switches
  - » Programmable die monitor inputs
  - » Six-digit part and batch counters
  - » Interlocked die safety block

# Features ... Delivery ... Value

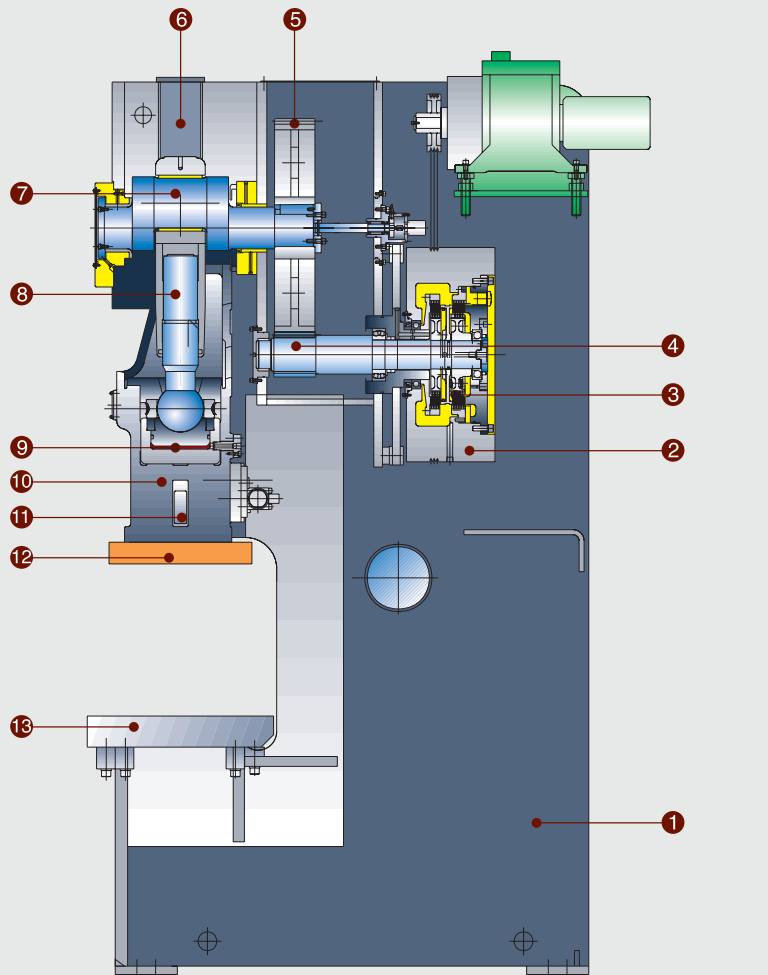

- |                       |                                 |                              |
|-----------------------|---------------------------------|------------------------------|
| 1. Press Frame        | 6. Counterbalance               | 11. Slide Knockout           |
| 2. Flywheel           | 7. Crankshaft                   | 12. Slide Plate (detachable) |
| 3. Wet Clutch & Brake | 8. Adjusting ScrewFrame         | 13. Bolster                  |
| 4. Pinion Drive Shaft | 9. Hydraulic Overload Protector |                              |
| 5. Main Gear          | 10. Slide                       |                              |

## OPTIONAL Features

- Link motion drive technology
- Press controls from industry leaders (Wintriss, Link, Rockwell Automation (Allen-Bradley), Siemens, Mitsubishi, etc.)
- Anti-vibration press leveling mounts
- Safety light curtains
- Tonnage monitor
- Quick die change system
- Die cushion
- Compact servo feed line

## Overload Protection

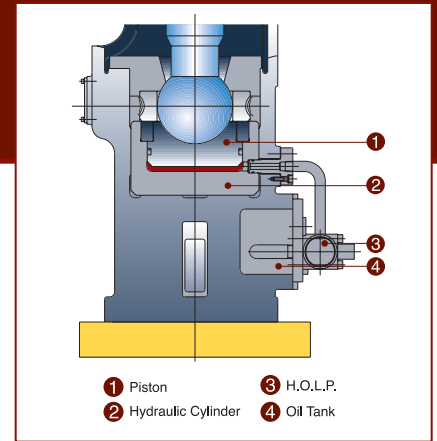

Fast response hydraulic overload relieves the pressure of a tonnage overload in milliseconds, stopping the press immediately. Hydraulic pressure is restored with the press of a button. Normal operation is inched to TDC. Your press and dies are effectively protected!

## Convenient Die Cushion Installation

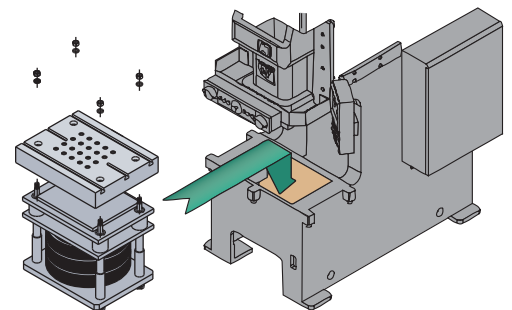

Fast response hydraulic overload relieves the pressure of a tonnage overload in milliseconds, stopping the press immediately. Hydraulic pressure is restored with the press of a button. Normal operation is inched to TDC. Your press and dies are effectively protected!

## Six-Point, Extra-Long Precision Gibbing

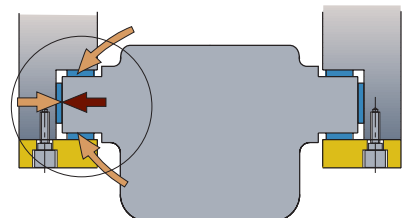

Extra-long gibs fully guide the slide during the working portion of the stroke. Force to the slide is delivered vertically, eliminating lateral thrust against the gibs, even under off-center loads.

Stroke-Capacity Diagram (L)

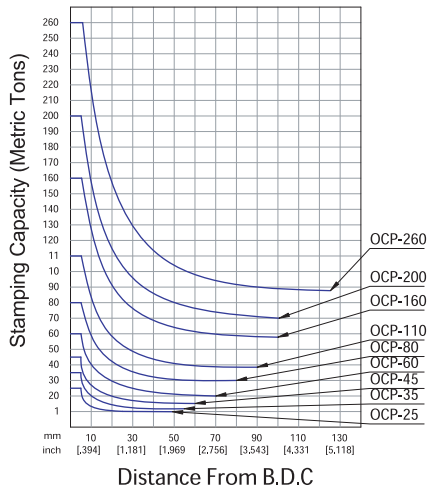

Stroke-Capacity Diagram (S)

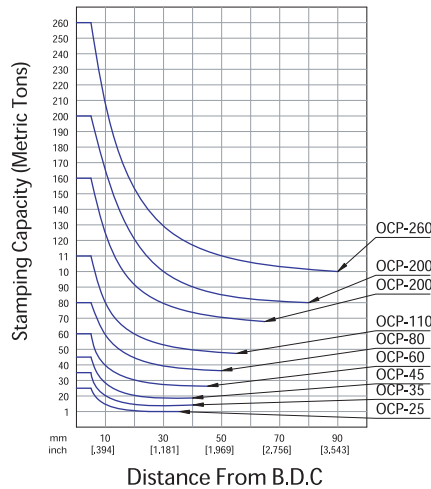

Stroke-Capacity Diagram (H)

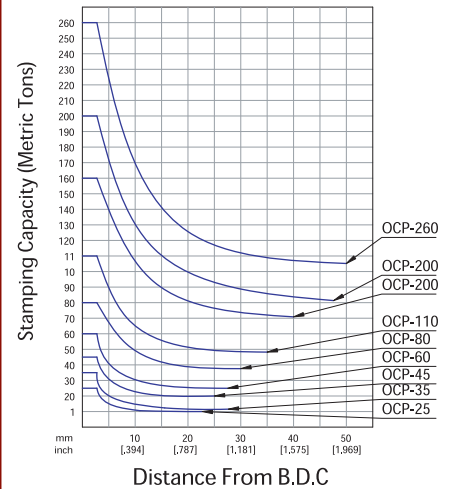

## Performance, Control, Torque & Reliability

Reliable and efficient performance from new wet clutch and brake design

The Stamtec wet clutch delivers rated torque at relatively low air pressure, reducing lining wear and air consumption. Lining life is extended by the effective heat dissipation resulting from the linings running in an enclosed oil bath.

Low inertia significantly reduces lining wear. High performance is combined with low vibration and noise. Higher single stroke rates are achieved.

The OCP Series is such a compact design, it allows a larger capacity press to be accommodated in the same space as a smaller press. The space required for (4) traditional presses is space enough for (5) OCP Series presses.

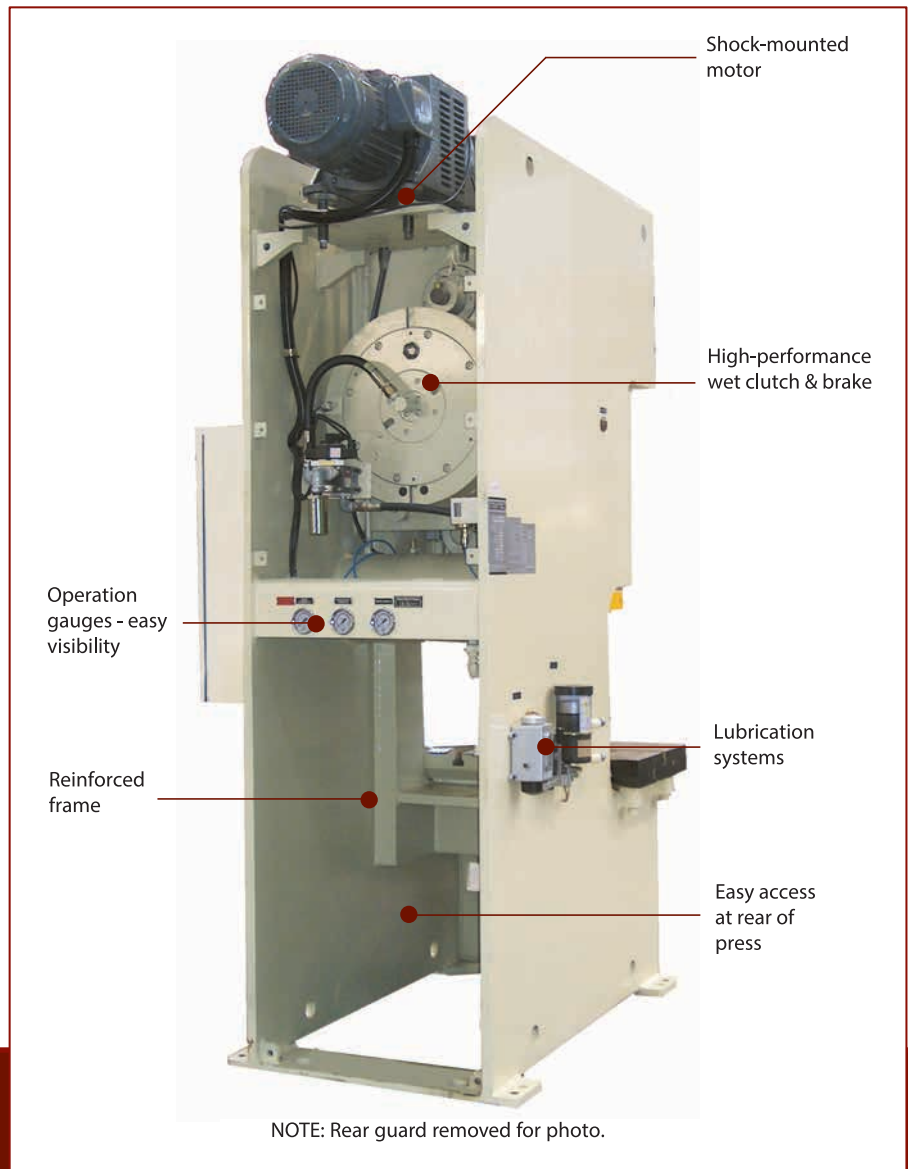

# Main Specifications

MODEL		OCP-25			OCP-35			OCP-45			OCP-60			OCP-80		
TYPE		S	H	L	S	H	L	S	H	L	S	H	L	S	H	L
Capacity	US Tons	27.5			38.85			50			66			88		
	Metric Tons	25			35			45			60			80		
Rated Tonnage (Above B.D.C.)	in. mm	0.13 3.2	0.06 1.6	0.13 3.2	0.13 3.2	0.06 1.6	0.13 3.2	0.13 3.2	0.09 2.3	0.13 3.2	0.16 4	0.09 2.3	0.16 4	0.20 5	0.13 3.2	0.20 5
Stroke Length	in. mm	2.76 70	1.57 40	3.94 100	3.15 80	1.77 45	4.33 110	3.15 80	1.97 50	4.72 120	3.54 90	2.17 55	5.51 140	3.94 100	2.36 60	6.30 160
Speed	SPM	75-140	95-180	55-100	70-135	90-180	50-95	65-130	85-175	50-95	60-120	80-165	40-85	55-110	75-150	40-75
Die Height	in. mm	9.65 245	9.65 245	9.06 230	9.84 250	9.84 250	9.25 235	9.84 250	9.84 250	10.63 270	10.63 270	10.63 270	11.81 300	11.81 300	11.81 300	12.99 330
Slide Adjustment	in. mm	1.97 50			2.17 55			2.36 60			2.76 70			3.15 80		
Bolster Area (LR x FB)	in. mm	28.35 x 9.06 720 x 230			30.71 x 13.40 780 x 340			33.50 x 14.18 850 x 360		33.5 x 17.3 850 x 440	35.44 x 15.75 900 x 400		35.44 x 20.48 900 x 520	39.38 x 18.11 1000 x 460		39.38 x 23.6 1000 x 600
Bolster Thickness	in. mm	2.76 70	3.34 85	2.76 70	2.76 70	3.34 85	2.76 70	3.54 90	4.13 105	3.54 90	3.54 90	4.13 107.5	3.54 90	3.94 100	4.72 120	3.94 100
Slide Area (LR x FB)	in. mm	13.78 x 11.81 350 x 300			14.96 x 12.60 380 x 320			16.93 x 13.78 430 x 350			19.68 x 15.75 500 x 400			22.10 x 18.11 560 x 460		
Main Motor (VS)	HP	5			5			7.5			7.5			10		
Slide Adjusting Motor	HP	Manual			Manual			0.2			0.3			0.3		

DIE CUSHION		OCP-25			OCP-35			OCP-45			OCP-60			OCP-80		
TYPE		S	H	L	S	H	L	S	H	L	S	H	L	S	H	L
Capacity	US Tons	-					2.9			2.9			4			6.9
Pad Area (LR x FB)	in. mm	- -					11.81 x 9.06 300x230			13.91 x 9.06 335 x 230			13.78 x 9.25 350 x 235			16.14 x 10.24 410 x 260
Stroke	in. mm	- -					1.97 50			2.36 50			2.76 70			2.76 70

MACHINE DIMENSIONS		OCP-25			OCP-35			OCP-45			OCP-60			OCP-80		
TYPE		S	H	L	S	H	L	S	H	L	S	H	L	S	H	L
Width (LR)	in. mm	35.43 900			36.61 930			41.33 1055			40.16 1020			43.82 1113		
Depth (FB)	in. mm	40.35 1025			47.24 1200			66.34 1685		67.91 1725	69.09 1755		71.46 1815	71.65 1820		74.41 1890
Height (H)	in. mm	73.62 1870			82.68 2100			90.75 2305		93.11 2365	98.23 2495		101.38 2575	108.82 2764		112.36 2854

OCP-110			OCP-160				OCP-200				OCP-260				OCP-300			
S	H	L	S	H	L	XL	S	H	L	XL	S	H	L	XL	S	H	L	XL
121			176				220				286				330			
110			160				200				250				300			
0.20 5	0.13 3.2	0.20 5	0.24 6	0.16 4	0.24 6	0.24 6	0.24 6	0.16 4	0.24 6	0.24 6	0.26 6.5	0.16 4	0.26 6.5	0.26 6.5	Available Upon Request			
4.33 110	2.76 70	7.09 180	5.12 130	3.15 80	7.87 200	9.84 250	5.91 150	3.74 95	7.87 200	9.84 250	7.09 180	3.94 100	9.84 250	11.81 300				
50-100	65-135	30-65	40-85	55-115	25-50	20-45	35-70	45-95	20-45	20-40	30-60	40-75	20-40	20-35				
12.60 320	12.60 320	13.78 350	13.78 350	13.78 350	15.75 400	17.72 450	16.14 410	16.14 410	17.72 450	17.72 450	18.11 460	18.11 460	19.69 500	21.26 540				
3.54 90			3.94 100				4.33 110				4.72 120							
45.28 x 20.48 1150 x 520		45.28 x 26.78 1150 x 680	49.2 x 23.6 1250 x 600		49.2 x 29.93 1250 x 760	53.15 x 29.9 1350 x 760	55.12 x 26.78 1400 x 680		55.12 x 32.3 1400 x 820	59 x 32.3 1500 x 820	59 x 27.6 1500 x 700		59 x 35.43 1500 x 900	69 x 35.43 1750 x 900				
4.72 120	5.51 140	4.72 120	5.91 150	6.89 175	5.91 150		6.29 160	7.88 187.5	6.29 160		7.09 180	8.66 220	7.09 180					
25.59 x 20.47 650 x 520			27.56 x 22.83 700 x 580				33.46 x 25.59 850 x 650				36.22 x 27.56 920 x 700							
15			15				20				25							
0.3			0.6				1				2							

OCP-110			OCP-160				OCP-200				OCP-260				OCP-300			
S	H	L	S	H	L	XL	S	H	L	XL	S	H	L	XL	S	H	L	XL
		8.8			11				15				15		Available Upon Request			
		19.69 x 11.81 500 x 300			21.26 x 13.78 540 x 350				25.20 x 18.50 640 x 470				27.56 x 18.50 700 x 470					
		3.15 80			3.15 80				3.94 100				3.94 100					

OCP-110			OCP-160				OCP-200				OCP-260				OCP-300			
S	H	L	S	H	L	XL	S	H	L	XL	S	H	L	XL	S	H	L	XL
49.02 1245			55.91 1420			59.06 1500	59.84 1520			62.20 1580	69.57 1767			81.38 2067	Available Upon Request			
80.51 2045		85.63 2175	85.83 2180		90.87 2308		94.69 2405		97.05 2465		88.19 2240		94.49 2400	100.39 2550				
115.35 2930		119.29 3030	128.74 3270		133.46 3390	137.40 3490	144.29 3665		147.83 3755	149.80 3805	153.39 4150		168.90 4290	172.44 4380				

## Bolster Dimensions

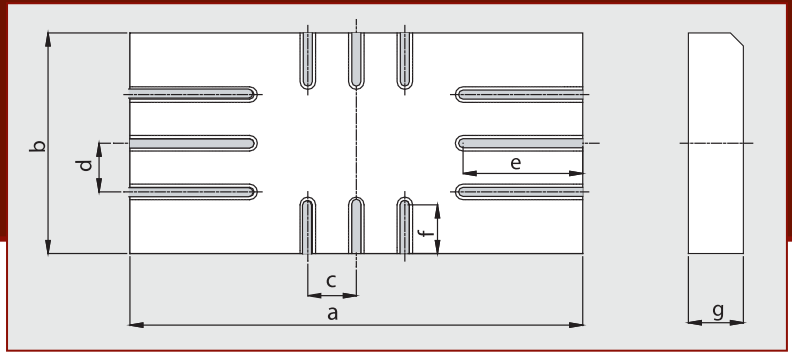

MODEL	OCP-25		OCP-35		OCP-45		OCP-60		OCP-80		OCP-110		OCP-160			OCP-200				OCP-260				OCP-300			
Type	S/H	L	S/H	L	S/H	L	S/H	L	S/H	L	S/H	L	S/H	L	XL	S	H	L	XL	S	H	L	XL	S	H	L	XL
Type of T-Slot	C		C		C		A		A		B		B			B				B				Available Upon Request			
a	in. mm	28.35 720	30.71 780		33.46 850		35.43 900		39.73 10000		45.28 1150		49.21 1250		53.15 1350	55.12 1400		59.06 1500	59.06 1500		68.90 1750						
b	in. mm	12.60 320	13.39 340		14.18 360	17.32 440	15.75 400	20.47 520	18.11 460	23.62 600	20.47 520	26.77 680	23.62 600	29.92 760	31.10 790	26.77 680	32.28 820	33.46 850	27.56 700	35.43 900							
c	in. mm	5.91 150	5.91 150		5.91 150		5.91 150		5.91 150		5.91 150		5.91 150			5.91 150				5.91 150							
d	in. mm	- -	- -		- -		- -		5.91 150		5.91 150		5.91 150			5.91 150				5.91 150							
e	in. mm	5.91 150	6.69 170		8.86 225		8.86 225		9.25 235		11.22 285		14.37 365			14.57 370				17.32 440							
f	in. mm	3.94 100	3.94 100		3.74 95		3.35 85		2.95 75		3.54 90		5.51 140			5.51 140				7.87 200							
g	in. mm	2.76 70	2.76 70		3.54 90		3.54 90		3.94 100		4.72 120		5.91 150			6.69 170				7.09 180							

## Slide Plate Dimensions

MODEL		OCP-25	OCP-35	OCP-45	OCP-60	OCP-80	OCP-110	OCP-160	OCP-200	OCP-260	OCP-300
Slide Plate (LRxFB)	in. mm	13.78 x 11.81 350 x 300	14.96 x 12.60 380 x 320	16.93 x 13.78 430 x 350	16.69 x 15.75 500 x 400	22.05 x 18.11 560 x 460	25.29 x 20.47 650 x 520	27.56 x 22.83 700 x 580	33.46 x 25.59 850 x 650	37.40 x 27.56 950 x 700	Available Upon Request
Type of T-Slot		C	C	C	A	A	B	B	B	B	
No. of T-Slot		2	2	2	2	2	2	4	4	4	
Shank Hold Diamter (D)	in. mm	1.50 38	1.50 38	1.50 38	1.97 50	1.97 50	1.97 50	2.56 65	2.56 65	2.56 65	
a	in. mm	- -	- -	- -	- -	- -	- -	- -	5.91 150	5.91 150	
b	in. mm	5.91 150	5.91 150	5.91 150	5.91 150	5.91 150	5.91 150	9.84 250	11.81 300	11.81 300	
c	in. mm	1.97 50	1.97 50	1.97 50	2.97 70	2.97 70	3.15 80	3.54 90	3.54 90	3.54 90	

## T-Slot Detail

Dim.	Type	A	B	C
a	in. mm	0.87 22	1.10 28	0.71 18
b	in. mm	1.46 37	1.89 48	1.18 30
c	in. mm	0.94 24	1.10 28	0.71 18
d	in. mm	0.63 16	0.79 20	0.47 12
R	in. mm	0.04 1	0.04 1	0.04 1

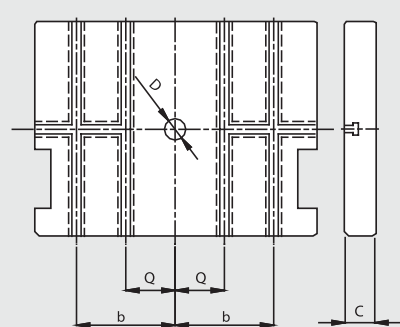
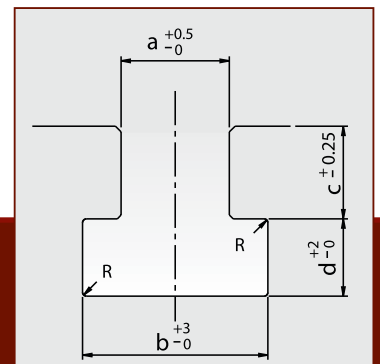

Slide Plate Dimensions



## Outline Dimensions

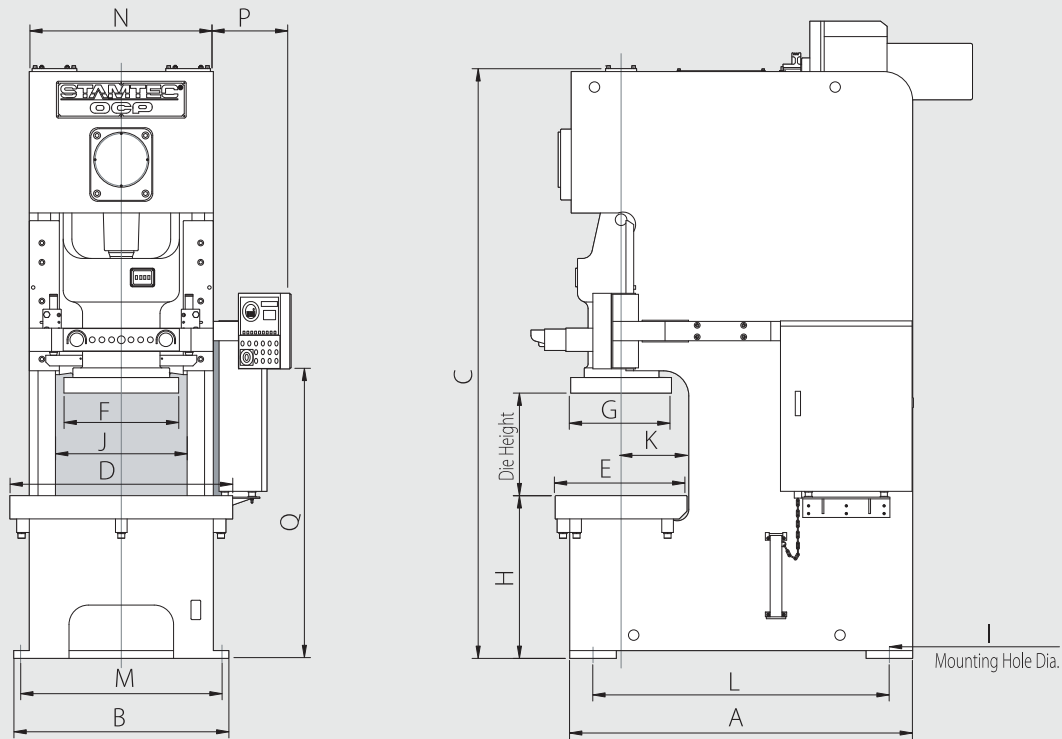

MODEL		OCP-25			OCP-35			OCP-45			OCP-60			OCP-80			OCP-110			OCP-160				OCP-200				OCP-260				OCP-300									
TYPE		S	H	L	S	H	L	S	H	L	S	H	L	S	H	L	S	H	L	S	H	L	XL	S	H	L	XL	S	H	L	XL	S	H	L	XL						
A	in. mm	40.35 1025			47.24 1200			51.96 1320		54.33 1380		57.99 1473		54.33 1380		57.99 1473		60.04 1525		65.94 1675		68.31 1735		70.28 1785		77.56 1970		85.83 2180		81.30 2065		86.42 2195		87.20 2215		88.19 2240		94.49 2400		100.39 2550	
B	in. mm	28.35 720			31.10 790			31.50 800			34.65 880			39.37 1000			43.70 1100			50.39 1280			53.54 1360		53.94 1370			56.30 1430		60.43 1535			64.96 1650								
C	in. mm	81.50 2070			87.01 2210			91.54 2325		93.11 2365		99.21 2520		101.37 2575		111.02 2820		113.39 2880		117.32 2980		119.88 30.45		130.31 3310		133.66 3395		137.4 3490		149.21 3790		151.77 3855		153.74 3905		163.39 4150		168.90 4290		172.44 4380	
D	in. mm	28.35 720			30.71 780			33.46 850			35.43 900			39.37 1000			45.28 1150			49.21 1250			53.15 1350		55.12 1400			59.06 1500		59.06 1500			68.90 1750								
E	in. mm	12.60 320			13.39 340			14.17 360		17.32 440		15.75 400		20.47 520		18.11 460		23.62 600		20.47 520		26.77 680		23.62 600		29.92 760		31.10 790		26.77 680		32.28 820		33.46 850		27.56 700		35.43 900			
F	in. mm	13.78 350			14.96 380			16.93 430			19.69 500			22.05 560			25.59 650			27.56 700			33.46 850			36.22 920															
G	in. mm	11.81 300			12.60 320			13.78 350			15.75 400			18.11 460			20.47 520			22.83 580			25.59 650			27.56 700															
H	in. mm	31.50 800	32.09 815	31.50 800	31.50 800	32.09 815	31.50 800	31.50 800	32.09 815	31.50 800	31.50 800	32.20 811	31.50 800	32.80 833	33.58 853	32.80 833	33.07 840	33.86 860	33.07 840	36.02 915	37.01 940	36.02 915		40.16 1020	41.26 1048	40.16 1020		43.31 1100	59.06 1500	43.31 1100											
I	in. mm	1.1 28			1.1 28			1.1 28			1.1 28			1.37 35			1.37 35			1.85 47			1.85 47			1.85 47															
J	in. mm	18.82 478			19.76 502			20.08 510			21.02 534			23.54 598			26.77 680			29.53 750			32.68 830		33.46 850			33.86 860		37.40 950			50.00 1270								
K	in. mm	6.50 165			6.89 175			7.48 190		9.06 230		8.27 210		10.63 270		9.45 240		12.20 310		10.63 270		13.78 350		65.07 310		15.35 390		16.54 420		13.78 350		16.54 420		17.72 450		14.17 360		18.11 460			
L	in. mm	31.97 812			38.58 980			46.97 1193		48.54 1233		48.03 1220		50.39 1280		52.48 1333		54.53 1385		61.22 1555		63.58 1615		64.37 1653		71.65 1820		71.65 1820		76.57 1945		74.80 1900		78.74 2000							
M	in. mm	25.59 650			28.35 720			29.53 750			32.28 820			35.83 910			40.94 1040			46.46 1180			49.61 1260		50.20 1275		52.56 1335		57.84 1460		66.93 1700										
N	in. mm	23.62 600			24.80 630			25.98 660			28.74 730			32.68 830			37.40 950			42.13 1070			45.28 1150		47.24 1200		48.62 1235		53.15 1350		64.93 1650										
P	in. mm	11.81 300			11.81 300			11.81 300			11.81 300			15.55 395			15.55 395			16.61 422			16.42 417			16.42 417															
Q	in. mm	- -			- -			- -			- -			47.56 1208		55.59 1412		55.91 1208		59.06 1500		57.68 1465		64.96 1650		42.52 1080		66.46 1688		74.80 1900		78.74 2000									



# Press Controls

User-friendly, fully programmable operation

Stamtec presses feature advanced, user-friendly automation controls with fully programmable on-screen displays for easy set-up, start-up, operation and diagnostics.

Our standard presses come equipped with **OmniLink 5100-MPC Press Automation Controls**.

Link's custom engineered OmniLink System 5100-MPC part revolution mechanical power press controls provide unmatched features and flexibility to achieve the ultimate in pressroom productivity and safety at modest cost.

OmniLink 805 Operator Terminal: The user friendly OmniLink 805 Operator Terminal uses a Color 5.7" LCD TFT with 640 x 480 pixel resolution and touch screen.

OmniLink System 5100-MPC Press Controls are designed to meet all functional safety requirements of current and anticipated OSHA 29 CFR 1910.217, ANSI B11.1, and CSA Z142 standards, and to provide safety features in addition to these standards when properly applied, adjusted, installed and used.

Stamtec presses can be CUSTOMIZED with your choice of press controls from:



## Quick Die Change System (Q.D.C.)

**Die Clamp TX-type**  
With "U" Cut in die set

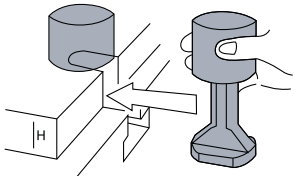

**Die Clamp TY-type**  
Die plate thickness, H, to be specified

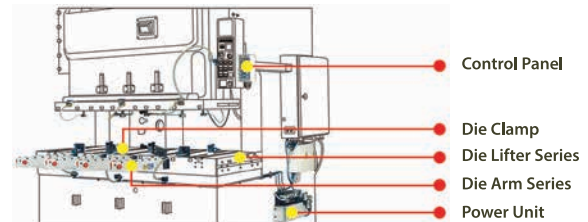
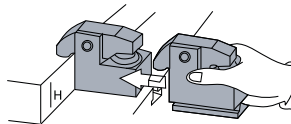

		Qty.	Model	OCP-25		OCP-35		OCP-45		OCP-60		OCP-80		OCP-110		OCP-160			OCP-200			OCP-260					
				Option		Option		Option		Option		Option		Option		Option			Option			Option					
				S	H	L	S	H	L	S	H	L	S	H	L	S	H	L	S	H	L	XL	S	H	L	XL	S
Die Clamp	Upper	TX-2 or TY-2	Clamping Force 2 tons / pc		4		4		4		4				4		4			4							
		TX-4 or TY-4	Clamping Force 4 tons / pc										4		4		4			4							
		TX-6 or TY-6	Clamping Force 6 tons / pc														4			4			4				
	Lower	TX-2 or TY-2	Clamping Force 2 tons / pc		4		4		4		4		4		4		4			4			4				
		TX-4 or TY-4	Clamping Force 4 tons / pc														4			4			4				
		TX-6 or TY-6	Clamping Force 6 tons / pc														4			4			4				
Die Lifter	DL28-400	Payload 1.1 tons / pc						2		2		2						2			2						
	DL28-500	Payload 1.2 tons / pc								2				2				2			2						
	DL28-600	Payload 1.4 tons / pc										2		2		2			2								
	DL28-700	Payload 1.5 tons / pc														2			2			2					
	DL28-800	Payload 1.6 tons / pc														2			2			2					
Die Lifter	RC-700-600	Payload 600Kg / pc		2		2		2		2		2		2			2			2			2				
	RC-800-80	Payload 800Kg / pc												2			2			2			2				
	RC-900-90	Payload 900Kg / pc												2			2			2			2				
		Hydraulic Power Unit FP6308U												1													



# STAMTEC®

METAL STAMPING & FORMING EQUIPMENT

Stamtec has been providing dependable, affordably priced metal stamping presses for almost 40 years in North America, and almost 70 years worldwide through our parent company Chin Fong. Our 72,000 sq. ft. sales, service, logistics, and assembly facility in Tennessee is home not only to North America's largest inventory of new presses and spare parts, but also our most important asset - our people. Our staff of engineering, sales, service, and support personnel are here to serve you in the most timely and professional manner. So, tap into our global strength, and grow with us as we grow with you!



## GAP FRAME PRESSES

1-POINT AND 2-POINT



## STRAIGHT SIDE PRESSES

1-POINT, 2-POINT AND 4-POINT



## SERVO PRESSES

1-POINT AND 2-POINT  
GAP AND STRAIGHT SIDE



## FORGING PRESSES

WARM / HOT AND COLD



## COIL FEEDING & HANDLING SYSTEMS

# STAMTEC®

METAL STAMPING & FORMING EQUIPMENT

## U.S.A. - STAMTEC, INC.

4160 Hillsboro Highway  
Manchester, TN 37355 U.S.A.

TEL: +1-931-393-5050

FAX: +1-931-393-5060

sales@stamtec.com

[www.stamtec.com](http://www.stamtec.com)



[www.STAMTEC.com](http://www.STAMTEC.com)